

INTL ASSN OF EXHIBITIONS & EVENTS CTC - SW SHOWCASE

01/17/24 - 01/17/24

KALAHARI RESORTS & CONVENTIONS TEXAS - KILIMANJARO BALLROOM - ROUND ROCK, TX

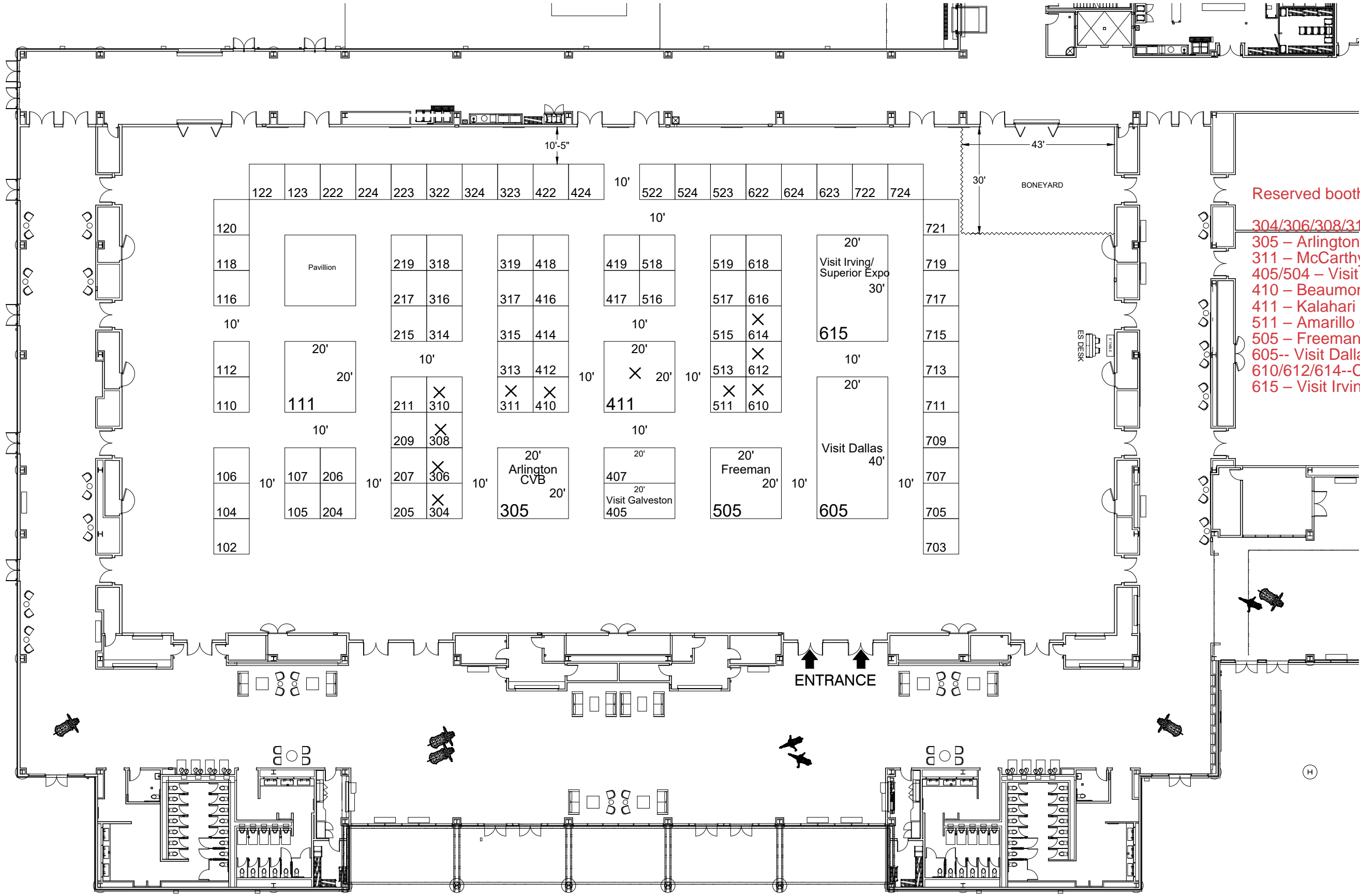

Reserved booths: (numerical order)
 304/306/308/310 – Visit Fort Worth
 305 – Arlington CVB
 311 – McCarthy Print
 405/504 – Visit Galveston
 410 – Beaumont CVB
 411 – Kalahari Resorts
 511 – Amarillo CVB
 505 – Freeman Decorating
 605-- Visit Dallas
 610/612/614--Corpus Christi
 615 – Visit Irving (w/ Superior Expo)

REVISION

Date: 8/11/2023
 By: Wilfred Wallen

BOOTH COUNT

Inventory as of 08/11/2023

Dimension	Size	Qty	SqFt
10'x10'	100	78	7,800
10'x20'	200	2	400
20'x20'	400	4	1,600
20'x30'	600	1	600
20'x40'	800	1	800
Totals:	86	11,200	

BLDG. LEGEND:

FLOOR PORT OUTLET LEGEND

	2 x 120V/20A + 2 x data
	4 x 120V/20A + 1 x data + 1AVV
	4 x 120V/20A + 1 x 208V/30A + 1 x data + 1AVV

DRAWING INFO

Passport Line Item Number:
#10549097
 Facility:
 KALAHARI RESORTS & CONVENTIONS TEXAS
 Facility Location:
 KILIMANJARO BALLROOM
 City & State:
 ROUND ROCK, TX
 Scale: CUSTOM
 Project #: 522467
 Acct. Sales: DANA KIRKHART
 Acct. Mgmt.: BLANCA CERDA
 Started: 8/10/2023
 Started By: WILFRED WALLEN
 Prod. Branch: SAN ANTONIO



Disclaimer - This floor plan is preliminary and subject to change pending review and official approval by all authorities having jurisdiction. Every effort has been made to ensure the accuracy of all information contained on this floor plan. However, no warranties, either expressed or implied, are made with respect to this floor plan. If the location of building columns, utilities or other architectural components of the facility is a consideration in the construction or usage of an exhibit, it is the sole responsibility of the exhibitor to physically inspect the facility to verify all dimension and locations.
 © Copyright 2023, Freeman Co. All rights reserved.

Confidential and Proprietary - the information contained herein is the proprietary information of Freeman and by accessing the information, the recipient agrees to keep the information confidential and not disclose it to any third party without the prior consent of Freeman. Recipient also agrees to only use the information for its internal evaluation purposes and for no other purpose, without the prior consent of Freeman.

File Path: C:\Vault\Designs\Projects\Intl Assn of Exhibitions & Events\IAEE2401\Event\Floor Plans\IAEE24.dwg | Tab Name: L1 0549097 FP